



Before you enjoy your
**NanoMax™ Portable Air Conditioner with
 Innovative AutoDrain NanoMist™ Technology™**
 it's important to read these easy set-up instructions.

For more information, please see the enclosed Owner's
 Manual, call **1-866-361-2233**, or visit
www.amcorgroupusa.com

IMPORTANT:
 Leave the
 Air Conditioner
 in an upright position
 for at least two hours
 before turning on!

1. Locate Parts

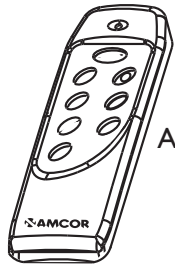

A. Remote Control

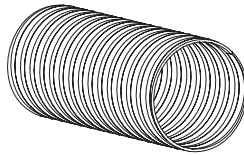

B. Exhaust Hose

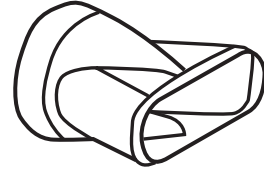

C. Slide Bar Connector

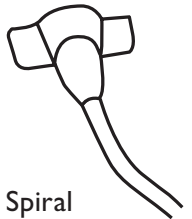

G. Spiral
 water pipe
 with connector

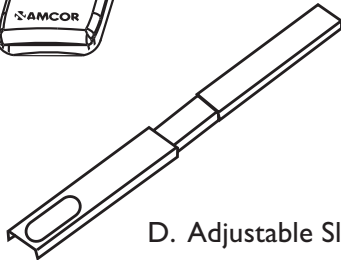

D. Adjustable Slide Bar



E. Insulation Strip

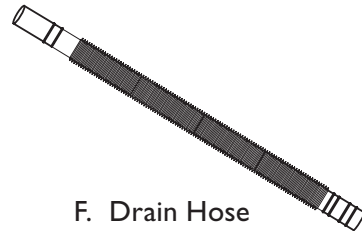

F. Drain Hose

2. Assemble AutoDrain NanoMist™ Technology

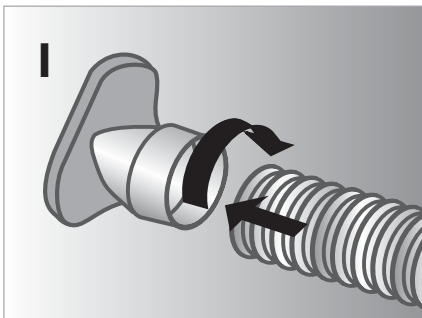

1 Attach Window
 Slide Bar
 Connector to
 Exhaust Hose
 by
 twisting as shown.

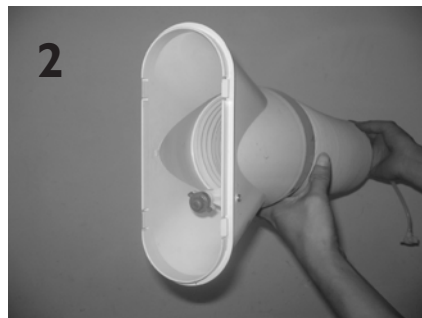

2 Put spiral water pipe
 into hot air
 flexible hose.

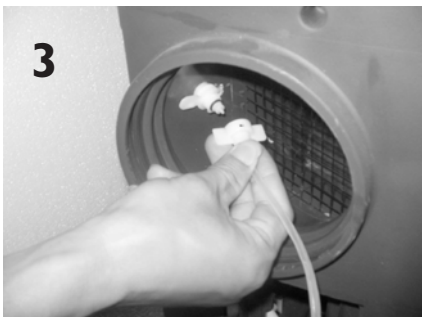

3 Connect the
 female half of the
 quick connector
 at the end of the
 spiral water pipe
 to the male part
 in the hot air
 outlet pipe.



4 Turn the
 connector
 90 degrees
 clockwise until it
 is locked in
 place.

Continued on Reverse Side

Continued from Reverse Side

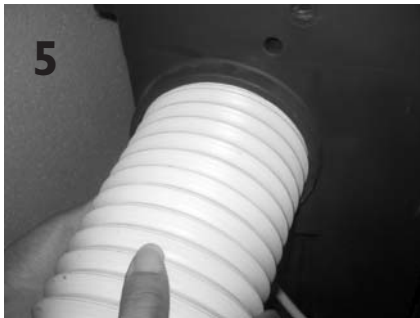

5 Assemble the hot air hose on the unit.

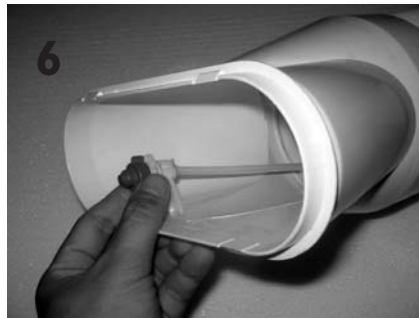

6 Clip on the water atomizer at the end of the spiral pipe to the holder.



7 Unfold flexible hose with attached hose adapter connector, and snap into Window Slide Bar.



Only Required For Disassembly.

In order to unlock the quick connector, push the tab and turn the connector 90 degrees counter-clockwise.

3. Installation of the Window Kit

1. Place Adjustable Slide Bar (D) in the window and expand so it fits tightly.
2. Mark Slide Bar to record width of the window.
3. Apply Insulation Strip (E) on top and bottom of Slide Bar.
4. Reposition Slide Bar Connector in the window. Expand the Slide Bar to fit tight. Tighten the screws.
5. Lower the window.
6. Make sure Hose has no kinks.

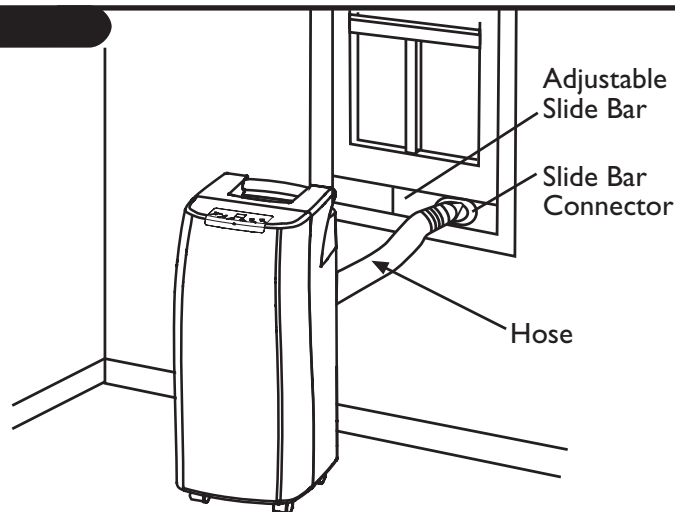

4. Turning the Unit On

1. Plug the unit into a working electrical outlet.
2. Press the unit's ON/OFF Button on the control panel. It may take a few minutes before cold air is dispersed.
3. If unit doesn't turn on, press top Reset Button on plug, shown at right, and plug back in outlet. Green light should be on.
4. Adjust FAN Speed by pressing the FAN Button until the preferred fan speed is reached.
5. Press the Timer Button to Set.

